



## Catalog sheet

### VAZ 3 payment machine for token dispensing

VAZ 3 is a vending machine for dispensing ZT 1 tokens. The machine is intended for use in places with unattended operation, e.g. in campsites in reception closing time or places with a larger number of devices put into operation using ZT 1 tokens.

After paying the required amount, the machine will issue the corresponding number of tokens. Payment can be made either with coins or with contactless payment cards or other bank NFC payment methods. The machine does not refund overpayments in coins. The machine has a supply of 600 tokens ready for sale. About the running out of tokens in the operator is informed by e-mail

The machine must be installed in a wall with access from both sides.

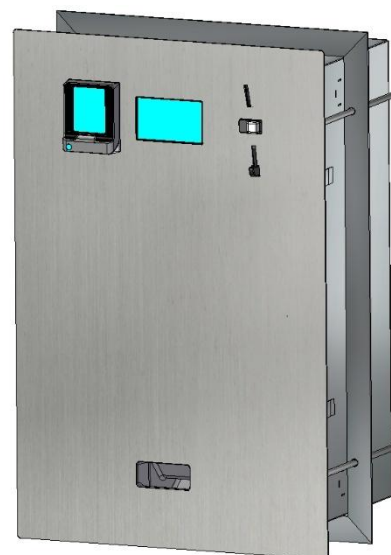

- The user accesses machine from one side, which only has a coin slot, or possibly a payment terminal, a slot for dispensing tokens and signaling. This side cannot be opened.
- The operator has access to the machine from the other side (back) after unlocking the door. This access is used to replace the coin trays and withdraw coins from the cash register.

The payment terminal is supplied by the operator - the recommended type is Ingenico - SELF 2000.

For easier insertion of tokens into the trays, we recommend using the VAZ 3 - token filler.

#### Complete delivery

- VAZ 3 payment machine for token dispensing
- Anchoring material

#### Standard versions

- VAZ 3 payment machine for token dispensing
- VAZ 3 - token filler

#### Technical details

- Usable coins: 1; 2; 5; 10; 20; 50 CZK, 0.1; 0.2; 0.5; 1; 2 € , ZT 2 tokens
- Maximum device capacity: 600 pcs ZT 1 - Order No. 1211990510, packed in 100 pcs.
- Supply voltage: 230 VAC
- Power consumption of the coin machine: 30 VA, when issuing tokens 50 VA
- Material: stainless steel AISI 304, brushed surface
- Modular equipment: payment terminal (supplied by the operator), recommended type Ingenico SELF 2000



## Construction readiness requirements

Prepare a hole in the wall according to the diagram. The hole must be rectangular and must not be slanted. The recommended height of the upper edge of the hole is 1500 ÷ 1700 mm. The machine is designed for installation in a wall with a thickness of 150–300 mm. If the front wall of the machine is on the outer shell of the building, the machine must be protected against rain - e.g. with a suitable roof.

- Prepared niche for installation: VAZ 3 710 mm x 440 mm, for walls with a thickness of 150–300 mm
- GOOSE NECK(S) outer diameter MAX.  $\varnothing$  40 mm – position according to drawing.
- Power cable 230 VAC, any two-wire with a wire cross-section of 0.5 - 1 mm<sup>2</sup>, e.g. CYSY 2 x 0.75.
- Ethernet cable, RJ45 connector (for connecting the control electronics and modular payment terminal to the Internet, according to local conditions)

## Diagram

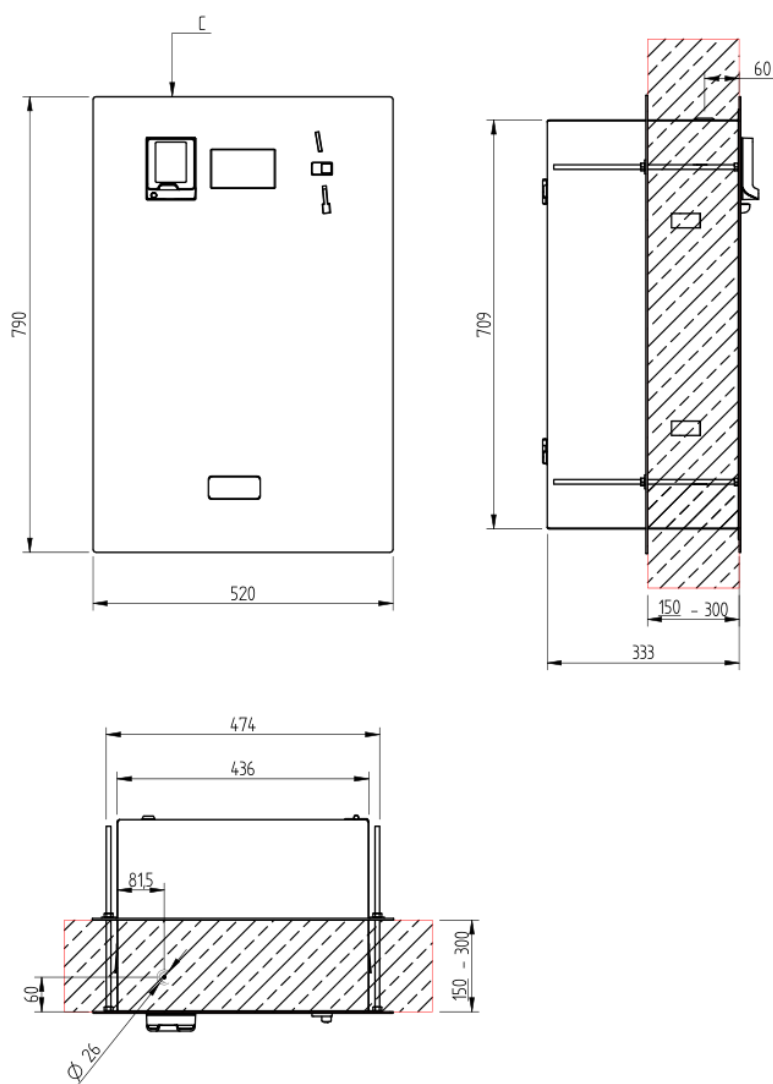

## Maintenance

For the treatment of stainless steel products, we recommend using Würth products – preservation (order no. 0893 121 K), cleaning (order no. 893 121 1). Do not use mechanical cleaning. Do not clean with aggressive agents, liquid sand or thinner. The coin acceptor can only be cleaned when the power is off. Cleaning the payment terminal according to the supplier's manual.