



Installation and operating instructions

K3x and K4x – Misting shower with 3 or 4 flowers

Intended use

- The misting shower is intended to make a water aerosol to cool the air or people.
- The water consumption is 6 l/hour per 1 nozzle at 0.3MPa or 40 l/hour (according to the nozzle used). The nozzle dimensions are the same and they can be replaced.

Installation

Pre-installation preparedness

1. Adequately large and firm concrete base must be ready for anchoring the shower.
2. The surface finish in the shower surroundings must be of anti-slip design.

Assembly

- **Warning!** – before finally connecting the water, it is necessary to thoroughly flush the water supply pipe to prevent escape of dirt from the pipe to the nozzles!
- 1. Fix the column to the ground according to the type of foundation structure (concreting of the anchoring structure (K4(3).B(BV)), or mounting of the clamps using chemical mortar (K4(3).S(SV)...)).
- 2. In case of usage of the concreting structures, they must be mounted in such a manner that the upper edge of the flange is max. 50 mm above ground level.
- 3. Connect the water supply.

Caution

- The site of the misting shower must be chosen in such a manner that there are no rising air flows in its vicinity (for example, a building that is blown by wind or where the wind rises along its wall)

- Before winter, it is necessary to dismantle the entire shower and store it in an object with a non-frost temperature, or dismantle all the nozzles and drain the water from the column. If the water freezes in the column, the column shall be damaged irreparably.

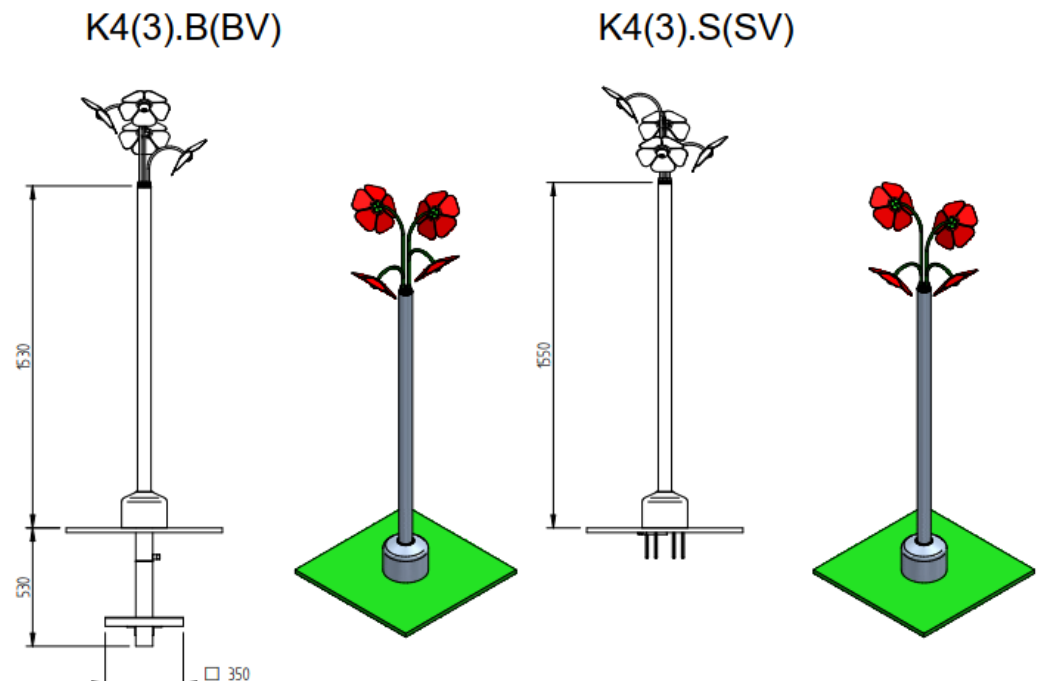



PRE-INSTALLATION PREPAREDNESS

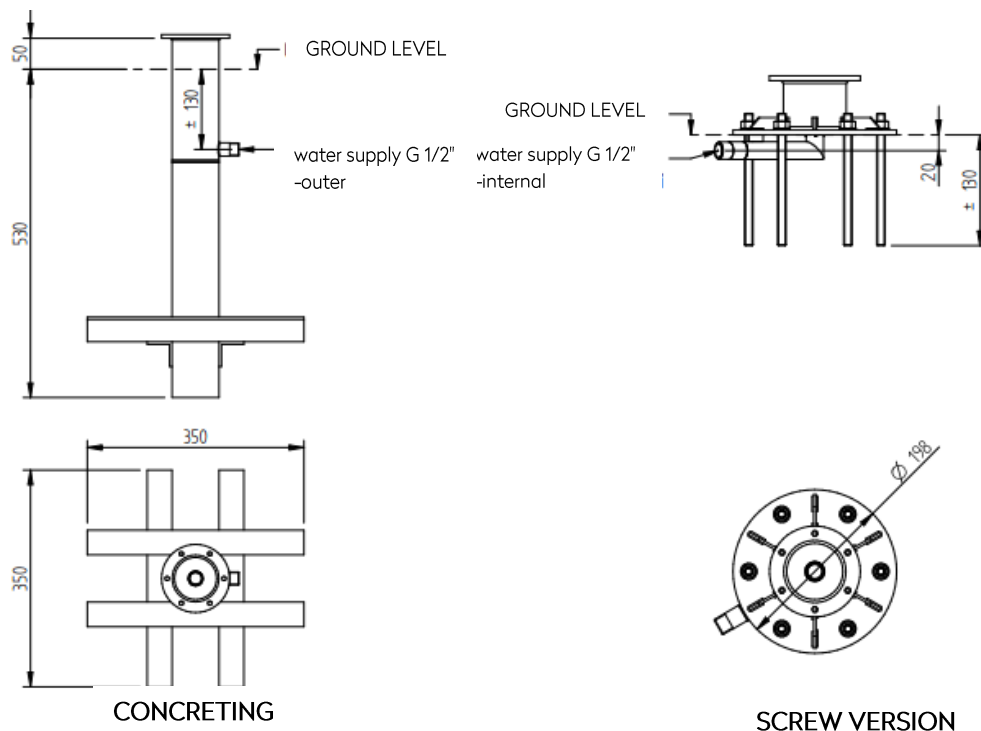

VALVE ASSEMBLY

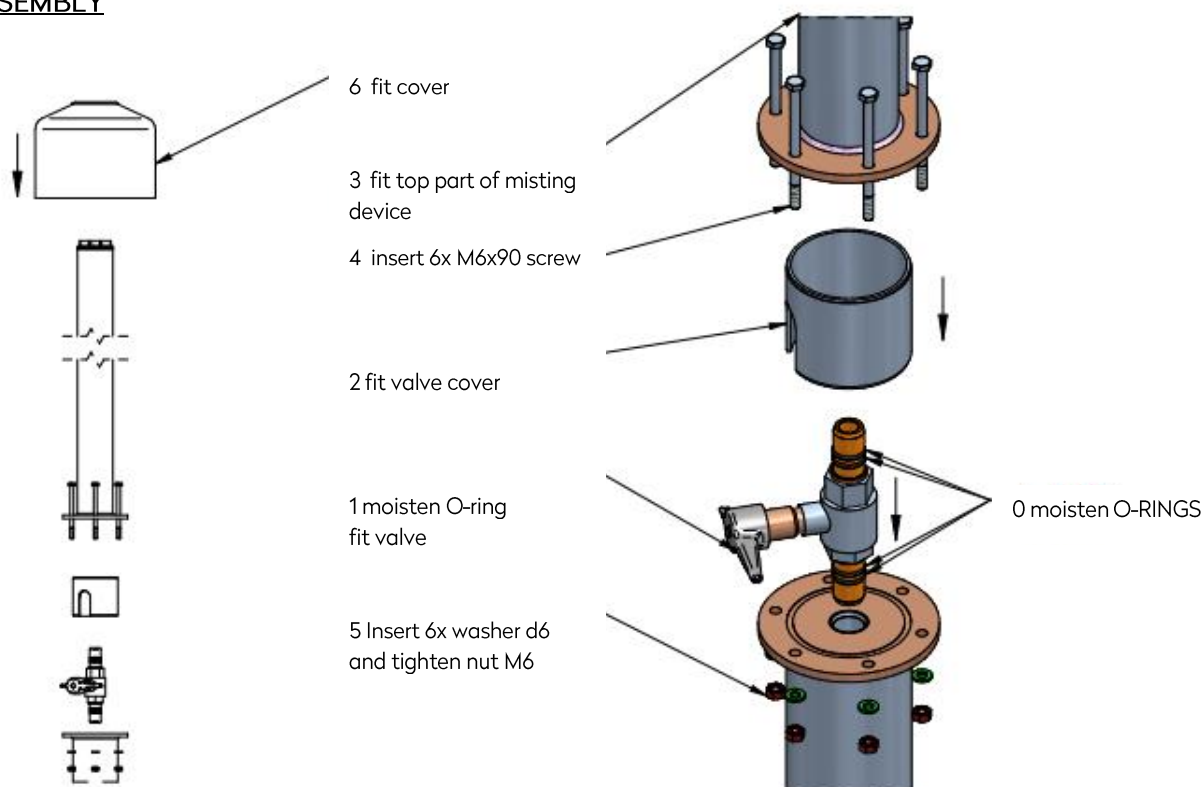

WARNING: AFTER INSTALLATION OF THE VALVE, CONNECT THE WATER AND THOROUGHLY FLUSH THE LINE TO THE MISTING FLOWER! THIS PREVENTS BLOCKING OF THE NOZZLE OF THE MISTING FLOWER.



ASSEMBLY OF THE MISTING FLOWERS

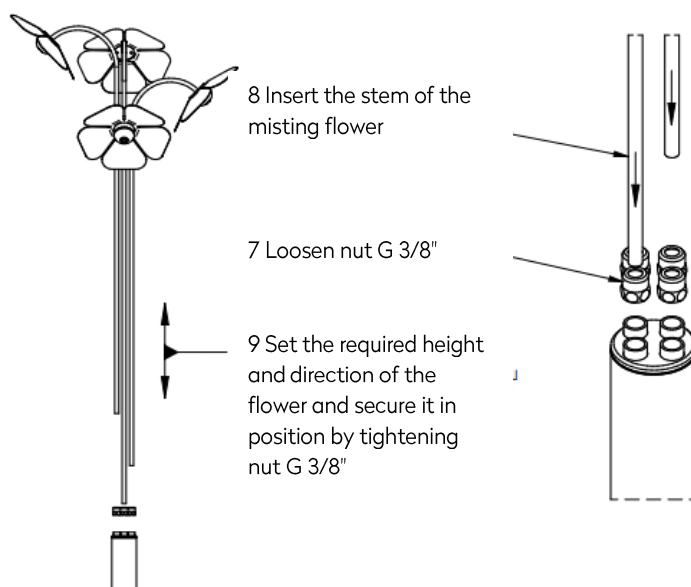

MISTING FLOWER CLEANING PROCEDURE

1. Zcela povolit chrom. matici 3/8\"/>



2. Zlehka vysunout matici 3/8\"/>



3. Povolit plochým šroubovákem šrouby na zadní straně květu.



4. Demontovat střed květu.





MISTING FLOWER CLEANING PROCEDURE

1. Completely loosen chrome nut G 3/8" using a flat spanner (Size 19).
2. Lightly take nut G 3/8" together with the plastic seal off the stem and cautiously pull the flower off to prevent damage to the paint on the stem.
3. Use a flat spanner to loosen the screws on the back of the flower.
4. Remove the middle of the flower.
5. Use a flat spanner to loosen and remove the chrome union nut (Size 19).
6. Remove the misting nozzle and filter.



7. Clean the misting nozzle and filter.



- Flush under flowing clean water and properly blow the nozzle with air.
- Re-assembly by reverse procedure.
- After re-assembly, it is necessary to test the tightness of all joints and eventually finally tighten the union nut.
- If flushing or blowing of the filter does not help, they are probably clogged with lime scale and must be cleaned using lime scale remover that does not damage brass and stainless steel.
- When cleaning, proceed according to the instructions of the manufacturer of the lime scale remover.

NOTE

- In case of frequent clogging of the nozzles, we recommend fitting a 20 or 5 micron filter element in front of the shower (as close to the shower as possible so that the length of the water supply pipe and filter are as short as possible). The sieve filter does not suffice.

Maintenance and cleaning

- The device was made from the stainless steel of quality corresponding with ČSN 17 240 (AISI 304) standard and, therefore, it must not be operated in chemically-aggressive environment.
- **Preparations containing chlorine must not be used for its cleaning!!**
- Cleaning agents by WÜRTH are recommended:
 - Metal renewal agent - Order No. 893 121 1
 - Stainless steel spray treatment - Order No. 0893 121 - K.
- If corrosion has already occurred, it can be removed with a cleaner INNOSOFT B 570 from the company Emergo.