



Installation and User Manual

BSK 01 – Automatic Safety Set with Connection to Cold and Thermally Treated Water

Technical data

Water flow time:

1–25 s (step 1 s) – default set 5 s for toilet
1–25 s (step 1 s) – default set 10 s for washbasin
1–25 s (step 1 s) – default set 5 s for drinking fountain

Pause time

0–40 min (step 10 s) default set 5 min for toilet
0–40 min (step 10 s) default set 1 min for washbasin
0–40 min (step 10 s) default set 0 min for drinking fountain

Supply voltage:

12 V, 50 Hz

Power consumption:

17 VA

Water pressure:

0,1 – 1,0 MPa

Recommended power supply:

ZAC 1/20 (max. 1 x BSK 01)

ZAC 1/50 (max. 3 x BSK 01)

Max. Temperature of Thermally Treated Water :

40°C

Product Website :

[BSK 01](#)

Description

- BSK 01 is a fully stainless steel safety set in an anti-vandal design, combining a toilet, washbasin, and drinking fountain into a single unit. BSK 01 is intended for wall mounting and connection to thermally treated water (for the washbasin) and cold water (for the drinking fountain and toilet). The washbasin is equipped with a spout without an aerator.
- When the button is pressed, water starts flowing and continues for the preset duration. After the water flow stops, pressing the button again will restart the flow. A delay time can be set after the second activation. If the button is pressed during the delay time, nothing happens and no water flows. The delay time can be set from 0 to 40 minutes. If the delay time is set to 0, the water can be turned on at any time by pressing the button.

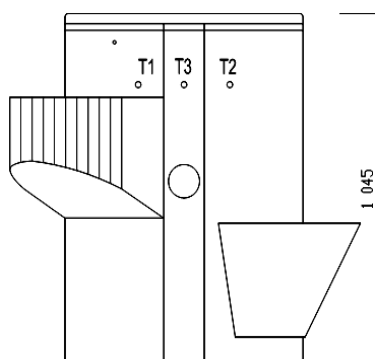

Right-side version

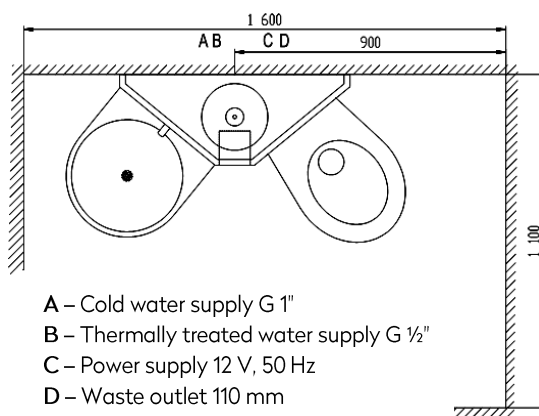
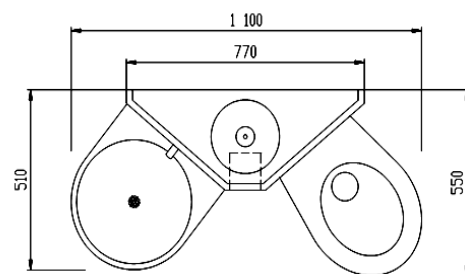

A – Cold water supply G 1"
B – Thermally treated water supply G 1/2"
C – Power supply 12 V, 50 Hz
D – Waste outlet 110 mm

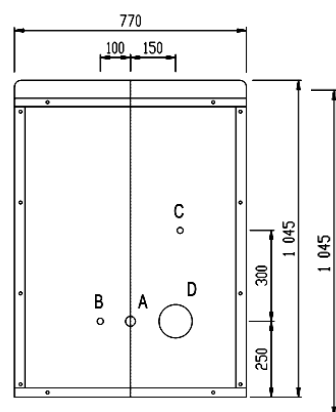



Adjustment procedure:

- **Entering setup mode:** Hold the magnet near the control LED – the LED will light up red. If the magnet is held briefly (less than 1 second), the LED will switch to green after removing the magnet, indicating the unit has returned to operating mode.
- **Setting water flow time:** Within 5 seconds of the LED lighting red, briefly press the button (water starts to flow). Press the button again to stop the water – the time between the two button presses is saved as the water flow time. The unit then returns to operating mode.
- **Setting pause time:** 5 seconds after the magnet is applied, the LED begins blinking red and green – this indicates pause time setup. Press the button to stop the setup. The pause time is set in 10-second increments (rounded down).
For example, if the button is pressed after 18 seconds, the pause time will be set to 10 seconds.
If no pause is desired (i.e., water can be activated anytime by pressing the button), the button must be pressed within 10 seconds of the LED starting to blink – this sets the pause time to 0, meaning no delay between activations.

Control LED States

Operating Mode

- **Solid green** – Powered on, ready for operation
- **Solid red** – Button pressed
- **Flashing green** – Valve is open
- **Solid orange** (red and green together) – Pause active

Setup Mode

- **Solid red** – Electronics entered setup mode
- **Flashing red** – Setting water flow time
- **Flashing alternately red and green** – Setting pause time

Warning

- The automatic safety set may only be connected to the ZAC power supply. The manufacturer does not guarantee reliable operation or accept responsibility for any damages resulting from connection to a different power source.
- Electrical installation may only be carried out by personnel with the appropriate qualifications and professional competence.
- Before commissioning, an initial inspection of the electrical system must be carried out in accordance with applicable standards.
- During operation, the operator is required to perform regular inspections of the electrical equipment.

Supplied parts

Casing with toilet, washbasin, and drinking fountain	1 pc	Angle valve with filter	1 pc
Screws and wall plugs	12 pc	Waste fitting with rubber sleeve	1 pc
Ball valve 1"	1 pc	Connection hoses	1 +1 pc
Solenoid valve	3 (1+2) pc	Safety screw M6	8 pc
Setup magnet	1 pc	Bit for safety screw	1 pc



Non-Warranty Faults and Their Remedies

Fault	Probable Cause	Remedy
Control LED does not light up after switching on	Power supply not connected or Connected to 230 V	Connect power supply Control unit irreparably damaged
Low water flow in washbasin or drinking fountain	Clogged filter	Clean the filter of the angle valve or the strainer before the solenoid valve
No water flow – LED lights green when button is pressed	Sensor malfunction	Adjust the distance between the sensor and the actuator pin
Water keeps flowing – electronics working correctly	Dirt in the solenoid valve	Clean the valve

Cleaning and Maintenance

Repairs and Adjustments

- For all repairs and adjustments (except time setting), the unit must be removed from the wall.

Cleaning the 1/2" Valve

- Unscrew the three screws holding the coil.
- Remove the coil, then carefully remove the plastic core cover (be careful not to lose the spring).
- Remove the diaphragm and clean the area underneath.
- Check the flow through both openings in the plastic center of the diaphragm, then reassemble the valve.
- When reassembling, be sure to follow the water flow direction – marked by an arrow on the valve.

Cleaning the 1" Valve, Diaphragm Replacement (valve disassembly not required).

- Shut off the water supply, loosen the union nut, and rotate the valve so that the flange faces you.
- Unscrew the six screws holding the flange. Remove the flange (watch for the spring), take out the diaphragm, and clean the space underneath.
- Check both openings in the diaphragm for blockages. Inspect the diaphragm for damage – ruptures typically occur near the outer edge.
- Reassemble the valve in reverse order.
- To remove the coil, slide out the locking pin at the bottom, turn the coil fully, and slide it out. You can now clean the core's sealing surface.
- Warning:** If the coil with its holder is rotated (after removing the plastic lock), water will flow continuously regardless of whether the valve is powered. Rotating only the coil (white cylinder with contacts) without the holder does **not** affect function.

Cleaning

- The unit is made of stainless steel according to ČSN 17 240 (AISI 304) and must not be used in chemically aggressive environments.
- !! Do not use any chlorine-containing products for cleaning!!**
- Recommended WÜRTH Products:
 - Metal surface restoration agent – Order No. 893 121 1
 - Stainless steel care spray – Order No. 0893 121 K.

Any other cleaning or installation method not specified here is **not permitted**.